

NOT IN SCOPE 

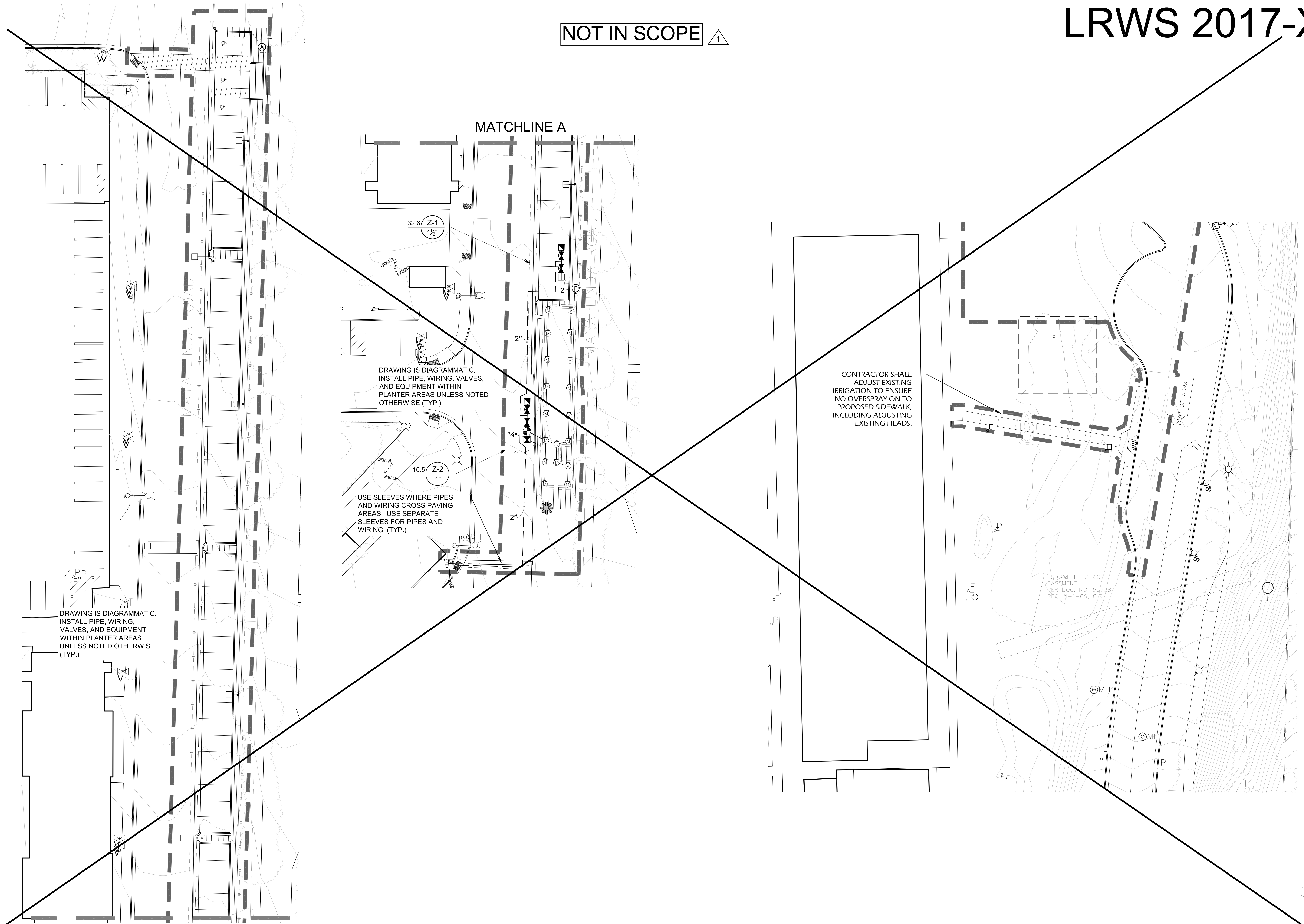

**SPECIAL NOTES FOR MIRAMAR COLLEGE:**  
THE FOLLOWING NOTES PROVIDED BY THE DISTRICT FOR CONTRACTOR REFERENCE:

**CAUTION:**  
1. THE CONTRACTOR MAY ENCOUNTER OLD MILITARY ORDINANCE. THE CONTRACTOR SHALL NOTIFY THE DISTRICT IMMEDIATELY IF THEY ENCOUNTER ANY ORDINANCE.

2. GEOTECHNICAL INVESTIGATIONS FOR THE SURROUNDING IMPROVEMENTS DESCRIBE THE UNDERLYING SOILS AS SANDY CLAY OVER HIGHLY CEMENTED GRAVEL AND COBBLE CONGLOMERATE (LINDA VISTA FORMATION AND STADIUM CONGLOMERATE). NO GROUNDWATER WAS ENCOUNTERED. TRENCHING INTO THE LINDA VISTA FORMATION AND STADIUM CONGLOMERATE WILL BE DIFFICULT AND MAY REQUIRE HEAVY EQUIPMENT.

SEE SHEET LI-2.1 FOR IRRIGATION SCHEDULE AND NOTES.  
SEE SHEETS LI-3.1 AND LI-3.2 FOR IRRIGATION DETAILS AND CALCULATIONS.

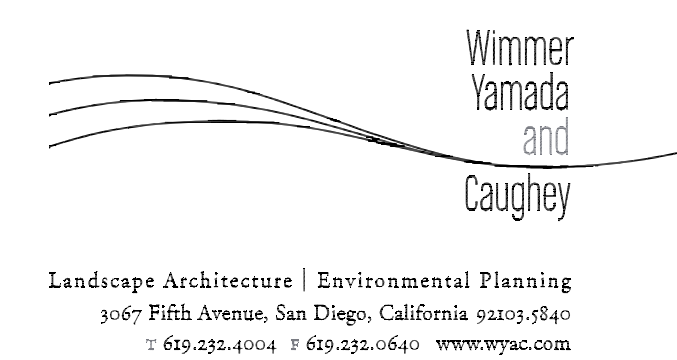
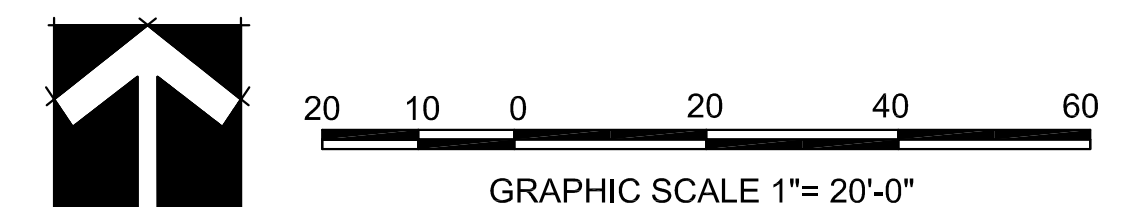
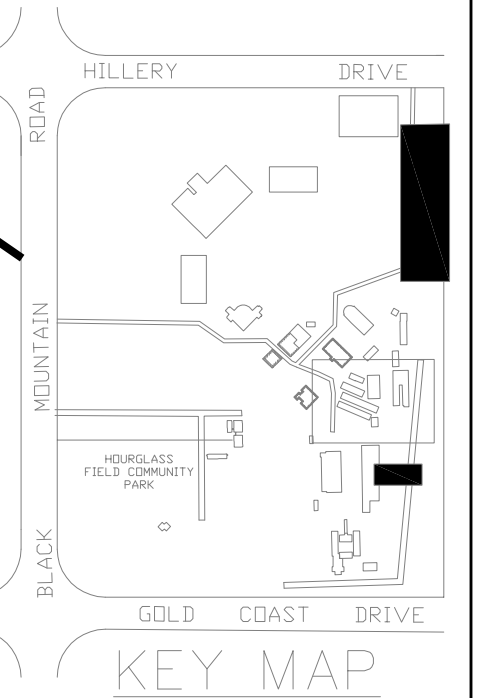

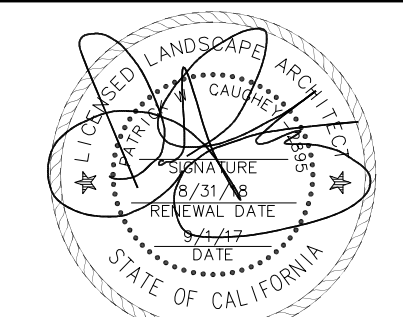
WYAC PROJECT #12-003.001		APPROVED BY		APPROVED BY		DRAWN		DATE	
						LE		SEPTEMBER 12, 2017	
LANDSCAPE ARCHITECT OF WORK		D.S.A.		DISTRICT ARCHITECT		CHECKED		SHEET	
PATRICK CAUGHEY						BH		22	
L.A. NO. 2895						REVISION		LI-1.1	
EXP. 08-31-16						1		OF	
						IRRIGATION PLAN		46	
						MIRAMAR COLLEGE INFRASTRUCTURE AND SITE DEVELOPMENT PHASE II ( SOUTH ) SCOPE "B"			
						SAN DIEGO COMMUNITY COLLEGE DISTRICT			

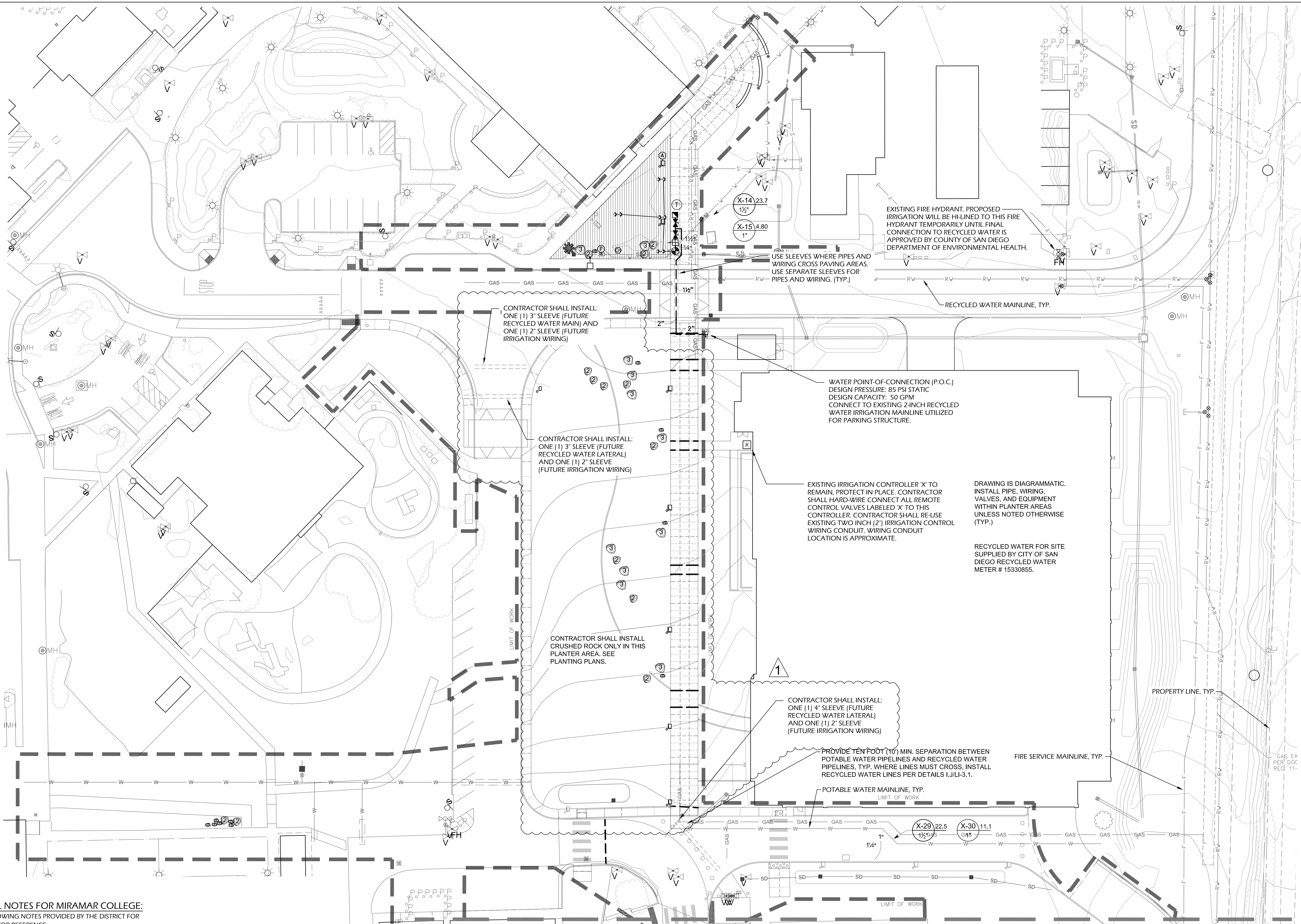

**SPECIAL NOTES FOR MIRAMAR COLLEGE:**  
THE FOLLOWING NOTES PROVIDED BY THE DISTRICT FOR CONTRACTOR REFERENCE:

**CAUTION:**  
1. THE CONTRACTOR MAY ENCOUNTER OLD MILITARY ORDNANCE. THE CONTRACTOR SHALL NOTIFY THE DISTRICT IMMEDIATELY IF THEY ENCOUNTER ANY ORDNANCE.

2. GEOTECHNICAL INVESTIGATIONS FOR THE SURROUNDING IMPROVEMENTS DESCRIBE THE UNDERLYING SOILS AS SANDY CLAY OVER HIGHLY CEMENTED GRAVEL AND COBBLE CONGLOMERATE (LINDA VISTA FORMATION AND STADIUM CONGLOMERATE). NO GROUNDWATER WAS ENCOUNTERED. TRENCHING INTO THE LINDA VISTA FORMATION AND STADIUM CONGLOMERATE WILL BE DIFFICULT AND MAY REQUIRE HEAVY EQUIPMENT.

**SEE SHEET LI-2.1 FOR IRRIGATION SCHEDULE AND NOTES.  
SEE SHEETS LI-3.1 AND LI-3.2 FOR IRRIGATION DETAILS AND CALCULATIONS.**

**CITY OF SAN DIEGO WATER PRESSURE ZONES:**

- 1) EXISTING RECYCLED WATER MAIN ON HILLERY DRIVE IS RECYCLED WATER PRESSURE ZONE No. 890 (ALL IRRIGATION SHOWN ON THESE PLANS IS RECYCLED WATER FROM THIS ZONE).
- 2) EXISTING POTABLE WATER IS PRESSURE ZONE No. 712.

CITY OF SAN DIEGO  
WORK ORDER No. 539264

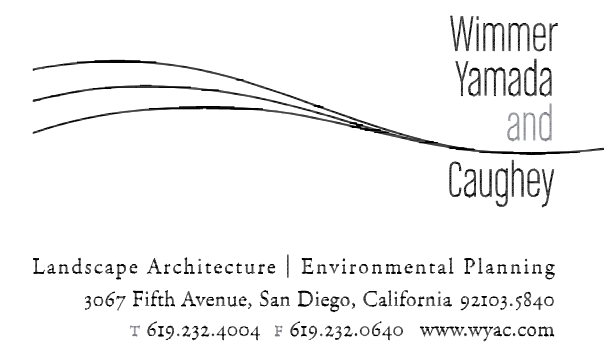

WYAC PROJECT #12-003.001

LANDSCAPE ARCHITECT OF WORK  
PATRICK CAUGHEY L.A. NO. 2895 DATE EXP. 08-31-16

APPROVED BY	APPROVED BY
D.S.A.	DISTRICT ARCHITECT

DRAWN	LE
CHECKED	BH
REVISION	

**IRRIGATION PLAN**

MIRAMAR COLLEGE  
INFRASTRUCTURE AND SITE  
DEVELOPMENT PHASE II ( SOUTH )  
SCOPE "B"

SAN DIEGO COMMUNITY COLLEGE DISTRICT

DATE	SEPTEMBER 1, 2017
SHEET	LI-1.2
OF	44

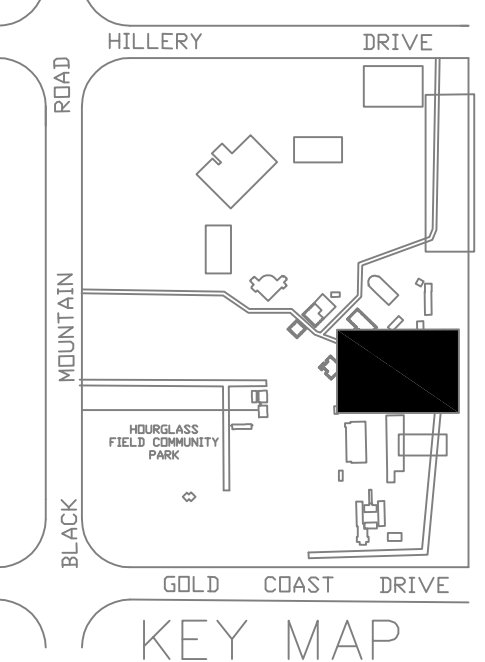
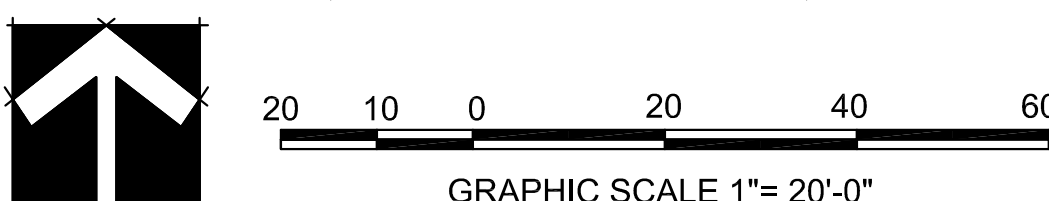

## IRRIGATION NOTES:

1. THE SPRINKLER SYSTEM DESIGN IS BASED ON THE MINIMUM STATIC PRESSURE OF 85 PSI, AND THE MAXIMUM FLOW DEMAND OF 50 GPM AT THE WATER POINT OF CONNECTION (P.O.C.). THE IRRIGATION CONTRACTOR SHALL VERIFY WATER PRESSURE PRIOR TO CONSTRUCTION AND SHALL REPORT ANY DIFFERENCES BETWEEN THE DESIGN WATER PRESSURE AND THE ACTUAL WORKING PRESSURE READING AT THE IRRIGATION P.O.C. TO OWNER'S REPRESENTATIVE.
2. THIS DESIGN IS DIAGRAMMATIC. THESE DRAWINGS ARE INTENDED TO BE A SCHEMATIC REPRESENTATION OF THE FINISHED IRRIGATION SYSTEM. ALL PIPING, VALVES, ETC. SHOWN WITHIN PAVED AREAS ARE FOR DESIGN CLARIFICATION ONLY AND SHALL BE INSTALLED IN PLANTING AREAS WHERE POSSIBLE. AVOID ANY CONFLICTS BETWEEN THE IRRIGATION SYSTEM, PLANTING, AND ARCHITECTURAL FEATURES. CONTRACTOR SHALL MAKE ALL NECESSARY FIELD ADJUSTMENTS TO ACCOMMODATE ACTUAL SITE CONDITIONS.
3. CONTRACTOR TO VERIFY ALL CONDITIONS AND DIMENSIONS SHOWN ON THESE PLANS AT THE SITE PRIOR TO COMMENCEMENT OF WORK.
4. CONTRACTOR SHALL NOT WILLFULLY INSTALL THE IRRIGATION SYSTEM AS SHOWN ON THESE DRAWINGS WHEN IT IS OBVIOUS THAT FIELD OBSTRUCTIONS AND/OR DIFFERENCES IN THE AREA DIMENSIONS EXIST THAT MAY NOT HAVE BEEN CONSIDERED IN THE SYSTEM ENGINEERING. SUCH OBSTRUCTIONS OR DIFFERENCES SHALL BE BROUGHT TO THE IMMEDIATE ATTENTION OF THE OWNER'S REPRESENTATIVE. IN THE EVENT THAT THIS NOTIFICATION IS NOT GIVEN, THE CONTRACTOR SHALL ASSUME FULL RESPONSIBILITY FOR ANY REVISIONS NECESSARY.
5. CONTRACTOR TO COORDINATE SLEEVING UNDER ALL PAVING WITH OTHER TRADES AS NECESSARY. NO TEES OR ELLS SHALL BE INSTALLED UNDER PAVING. ALL SLEEVES SHALL EXTEND A MINIMUM OF TWENTY-FOUR INCHES (24") BEYOND EDGE OF PAVING. ALL SLEEVING LOCATED UNDER PAVING SHALL BE TWO (2) TIMES THE OUTSIDE DIAMETER OF THE PIPE TO BE SLEEVED, MINIMUM TWO-INCH (2") DIAMETER. CONTRACTOR TO INSTALL METALLIC BACKED TAPE ALONG THE ENTIRE LENGTH OF THE SLEEVE, TWELVE INCHES (12") DIRECTLY ABOVE THE SLEEVE. TAPE SHALL BE MARKED "IRRIGATION" IN TWO INCH (2") CAPITAL LETTERS EVERY THREE FEET ALONG THE TAPE.
6. REMOTE CONTROL VALVES SHALL BE INSTALLED ADJACENT TO WALKWAYS UNLESS OTHERWISE NOTED.
7. CONCRETE THRUST BLOCKS SHALL BE USED ON ALL IRRIGATION MAINLINES WHERE CHANGES OF DIRECTION OF FORTY-FIVE (45) DEGREES OR MORE SHOULD OCCUR.
8. WHERE TREES, LIGHT STANDARDS, ETC., ARE AN OBSTRUCTION TO IRRIGATION COVERAGE, THEN PIPING AND SPRINKLER HEADS SHALL BE ADJUSTED AND/OR RELOCATED AS NECESSARY TO OBTAIN FULL COVERAGE AND MINIMUM OVERSPRAY. DO NOT EXCEED SPACING AS PER MANUFACTURER'S RECOMMENDATIONS.
9. CONTRACTOR SHALL FLUSH ALL MAIN LINES PRIOR TO INSTALLATION OF THE VALVES, AND SHALL FLUSH ALL LATERAL LINES PRIOR TO INSTALLATION OF THE SPRINKLER HEADS.
10. CONTRACTOR SHALL FINE-TUNE AND ADJUST ALL SPRINKLER SYSTEMS TO ACHIEVE OPTIMUM PERFORMANCE AND COMPLETE COVERAGE, WITH MINIMUM OVERSPRAY ONTO HARDSCAPE AREAS. THIS INCLUDES ADJUSTMENT OF THE FLOW CONTROL STEM AT EACH REMOTE CONTROL VALVE TO OBTAIN THE OPTIMUM OPERATING FLOW / PRESSURE FOR THAT SYSTEM, AND ADJUSTMENT OF ALL SPRINKLER NOZZLES.
11. COORDINATE IRRIGATION WORK WITH PLANTING PLANS TO AVOID CONFLICTING LOCATIONS BETWEEN PIPING AND PLANT PITS. SPECIMEN TREE LOCATIONS TAKE PRECEDENCE OVER IRRIGATION PIPING. LOCATE SPECIMEN TREES PRIOR TO TRENCHING FOR IRRIGATION PIPING.
12. ALL LATERAL END RUNS ARE AS PER CONTRACT DOCUMENTS.
13. TRENCH MARKER: ALL DIRECT BURIAL WIRES SHALL BE MARKED WITH A CONTINUOUS RED COLORED TRENCH MARKER TAPE PLACED NINE INCHES (9") BELOW FINISH GRADE DIRECTLY ABOVE THE BURED WIRE. MARKER TAPE SHALL BE EQUAL TO "ALAMA TAPE" AS MANUFACTURED BY PAUL POTTER WARNING TAPE INC. TAPE SHALL BE FOUR INCHES (4") WIDE.
14. IRRIGATION SYSTEMS ARE TO BE INSTALLED AS DESIGNED AND IN ACCORDANCE WITH THE CRITERIA AND APPLICABLE STANDARDS AS OF THE APPROVED DATE OF THESE PLANS. ALL IRRIGATION SYSTEM COMPONENTS SHALL BE INSTALLED PER LOCAL CODE. CONTRACTORS SHALL SECURE ALL NECESSARY PERMITS.
15. FOR REMOTE CONTROL VALVE MANIFOLDS, BALL VALVE SIZE SHALL EQUAL THE SIZE OF THE LARGEST REMOTE CONTROL VALVE IN THE MANIFOLD.
16. PROVIDE PULL BOXES FOR CONTROL WIRING AT ALL CHANGES IN DIRECTION GREATER THAN FORTY-FIVE (45) DEGREES AND WHERE WIRE RUNS EXCEED THREE HUNDRED FEET (300') IN LENGTH. IN-LINE WIRE SPLICES SHALL BE MADE ONLY IN PULL BOXES, WITH WATERPROOF CONNECTORS.
17. CONTRACTOR SHALL PROVIDE ONE (1) SET OF EXTRA CONTROL WIRES PER MANIFOLD.
18. BACKFILL MATERIAL SHALL BE CLEAN AND FREE OF DEBRIS, ROCKS LARGER THAN ONE INCH (1"), AND OBJECTS WITH SHARP EDGES.
19. CONTRACTOR SHALL INSTALL IN-LINE ANTI-DRAIN VALVES AS WARRANTED BY SITE CONDITIONS TO ALLEVIATE LOW-HEAD DRAINAGE.
20. ALL SPRINKLER HEADS SHALL BE SET PERPENDICULAR TO THE FINISH GRADE OF THE AREA TO BE IRRIGATED, UNLESS OTHERWISE DESIGNATED ON THE PLANS. ADJUST THE ANGLE OF RISERS FOR SPRINKLER HEADS ON SLOPES TO ACHIEVE OPTIMUM COVERAGE AND MINIMUM OVERSPRAY.
21. INSTALL VARIABLE ARC NOZZLES ON POP-UP SPRAY HEADS AT LOCATIONS WHERE ARCS OTHER THAN 90, 180, AND 360 DEGREES ARE REQUIRED, IN ORDER TO ACHIEVE COMPLETE COVERAGE WITH MINIMUM OVERSPRAY OF WATER ONTO HARDSCAPE AREAS.

## RECYCLED WATER NOTES:

1. 48 HOURS PRIOR TO COMMENCEMENT OF ANY EXCAVATION ON SITE IMPROVEMENTS, CONTRACTOR SHALL NOTIFY CITY OF SAN DIEGO, WATER DEPARTMENT, RECYCLED WATER SECTION AT (619) 539-7557.
2. ALL WORK SHALL BE DONE IN ACCORDANCE WITH THE CITY OF SAN DIEGO "RULES AND REGULATIONS FOR RECYCLED WATER USE AND DISTRIBUTION WITHIN THE CITY OF SAN DIEGO", APRIL 1996 AND THE SAN DIEGO DEPARTMENT OF ENVIRONMENTAL HEALTH REQUIREMENTS.
3. ALL BACKFLOW PREVENTER INSTALLATIONS AND LOCATIONS SHALL BE SUBJECT TO APPROVAL BY THE CITY OF SAN DIEGO WATER DEPARTMENT.
4. ALL PUBLIC FACILITIES, SUCH AS COMFORT STATIONS, DRINKING FOUNTAINS, DESIGNATED OUTDOOR EATING AREAS, ETC. SHALL BE PROTECTED FROM SPRAY AND/OR MISTING BY RECYCLED WATER.
5. NO PONDING, RUN-OFF OR OVER-SPRAY IS PERMITTED. ADJUST ALL SPRINKLER HEADS TO PREVENT OVER SPRAYING ONTO SIDEWALKS, STREETS, PRIVATE LOTS, AND NON-DESIGNATED USE AREAS.
6. HOSE BIBS ON RECYCLED WATER SYSTEMS ARE PROHIBITED.
7. ON-SITE CROSS CONNECTION BETWEEN RECYCLED WATER LINES AND POTABLE IS STRICTLY PROHIBITED.
8. QUICK COUPLING VALVES USED IN RECYCLED WATER SYSTEMS SHALL CONFORM TO THE FOLLOWING:
  - A. TYPE APPROVED FOR RECYCLED WATER USE WITH A NORMAL WORKING PRESSURE OF 150 P.S.I.
  - B. RECYCLED WATER QUICK COUPLER MUST BE DIFFERENT FROM POTABLE WATER QUICK COUPLER VALVES.
  - C. IN ORDER TO PREVENT UNAUTHORIZED USE, THE VALVE SHALL BE OPERATED ONLY WITH A SPECIAL COUPLER KEY WITH AN ACME THREAD FOR OPENING AND CLOSING THE VALVE.
  - D. THE COVER SHALL BE PERMANENTLY ATTACHED TO THE QUICK COUPLING VALVES. IT SHALL BE PURPLE RUBBER OR PURPLE VINYL.
  - E. LOCKING COVERS ARE REQUIRED.
9. NO SUBSTITUTION OF PIPE MATERIALS WILL BE ALLOWED WITHOUT PRIOR APPROVAL BY THE CITY OF SAN DIEGO.
10. INSTALL APPROVED, METALLIC BACKED AND STENCILLED WARNING TAPE OVER ALL PRESSURE RECYCLED WATER LINES. STENCIL AND COLOR CODE (PURPLE PANTONE # 522) ALL IRRIGATION PIPE, ORIENT THE STENCILING TO THE TOP OF THE TRENCH.
11. PROVIDE A MINIMUM OF AT LEAST 18 INCHES OF COVERING OVER ALL WIRING AND PIPING.
12. OPERATE THE IRRIGATION SYSTEM ONLY BETWEEN 9:00 PM AND 6:00 AM.
13. WHEN POTABLE WATER LINES AND RECYCLED WATER LINES CROSS, THE RECYCLED LINE SHALL BE INSTALLED WITHIN A PROTECTIVE SLEEVE. THE SLEEVE SHALL EXTEND 10 FEET FROM EACH SIDE, FROM THE CENTER LINE OF POTABLE LINE FOR A TOTAL OF 20 FEET.
14. MAINTAIN A 10 FOOT HORIZONTAL SEPARATION BETWEEN POTABLE WATER AND RECYCLED WATER OR SEWER LINES. INSTALL SEWER LINE BELOW RECYCLED WATER LINE AND RECYCLED WATER LINE BELOW THE POTABLE WATER LINE.
15. PROVIDE A MINIMUM OF 12 INCHES OF VERTICAL SEPARATION BETWEEN POTABLE/ RECYCLED WATER/SEWER.
16. THE SITE IRRIGATION SYSTEMS AS SHOWN ON THESE DOCUMENTS WILL UTILIZE POTABLE WATER UNTIL SUCH TIME AS THE CITY OF SAN DIEGO MAKES RECYCLED WATER AVAILABLE TO THE SITE.
17. INSTALL PURPLE COLORED PANTONE # 522 MATERIAL FOR ALL ABOVE GROUND IRRIGATION FACILITIES:
  - VALVE AND OTHER ON GRADE BOXES - INTEGRAL COLOR.
  - BACKFLOW DEVICES - PAINTED 2 COATS OF ENAMEL.
  - SPRINKLER HEADS - INTEGRAL COLOR PLASTIC.
18. TAG ALL VALVES AND OTHER BELOW GRADE FACILITIES WITHIN BOXES WITH PERMANENT RECYCLED WATER LABELS THAT ID THE FACILITY AS "RECYCLED WATER -DO NOT DRINK" IN BOTH SPANISH AND ENGLISH. ATTACH THE LABEL WITH EITHER STAINLESS STEEL WIRE OF SELF LOCKING PLASTIC TIES.
19. THE REQUIRED "CROSS CONNECTION TEST" SHALL BE DONE BY THE CITY OF SAN DIEGO AND THE SAN DIEGO COUNTY DEPARTMENT OF ENVIRONMENTAL HEALTH PRIOR TO ANY USE OF RECYCLED WATER. COPIES OF INSPECTION REPORTS WILL BE FORWARDED TO THE NON-INSPECTING PARTY.
20. THE DESIGN LOCATIONS PROPOSED FOR RECYCLED WATER "DO NOT DRINK" SIGNS SHALL BE CALLED OUT ON THE PLANS.
21. AN ANNUAL CROSS CONNECTION INSPECTION WILL BE DONE BY THE CITY OF SAN DIEGO SUBJECT TO APPROVAL BY THE SAN DIEGO COUNTY DEPARTMENT OF ENVIRONMENTAL HEALTH. COPIES OF THE INSPECTION REPORTS WILL BE FORWARDED TO THE NON-INSPECTION PARTY.
22. PRIOR TO CONVERSION TO RECYCLED WATER, AN ON-SITE SUPERVISOR SHALL BE DESIGNATED IN WRITING. THIS INDIVIDUAL SHALL BE FAMILIAR WITH PLUMBING SYSTEMS WITHIN PROPERTY, WITH THE BASIC SPECIFIC REQUIREMENTS OF RECYCLED WATER SYSTEMS. THE DESIGNATED "SITE SUPERVISOR" SHALL ATTEND THE COUNTY WATER AUTHORITIES CLASS FOR RECYCLED WATER SITE SUPERVISORS. COPIES OF THE SITE SUPERVISORS CERTIFICATE, WITH A 24-HOUR CONTACT NUMBERS SHALL BE PROVIDED TO THE CITY OF SAN DIEGO AND THE COUNTY DEPARTMENT OF ENVIRONMENTAL HEALTH.

IN CASE OF EMERGENCY CONTACT: ROY KINLEY AT (619) 388-7823

AFTER HOURS CONTACT: MIRAMAR COLLEGE POLICE DEPARTMENT DISPATCH AT (619) 388-6405

23. A PHYSICAL SEPARATION SHALL BE PROVIDED BETWEEN ADJACENT AREAS OF IRRIGATION WITH RECYCLED WATER AND POTABLE WATER. SEPARATION SHALL BE PROVIDED BY CONCRETE MOW STRIPS, CHAIN FENCES, OR OTHER MEANS AS APPROVED BY THE WATER DISTRICT AND DEPARTMENT OF ENVIRONMENTAL HEALTH.
24. CALL OUT ON THE PLANS IF THERE ARE OR ARE NOT ANY DRINKING FOUNTAINS AND/OR DESIGNATED OUTDOOR EATING AREAS ON THE SITE.
25. ALL PUBLIC AND PRIVATE POTABLE WATER MAINS INCLUDING FIRE MAINS AND ANY WATER WELLS AND WATER COURSES WITHIN THE RECYCLED WATER PROJECT SHALL BE SHOWN ON THE PLANS.
26. EDUCATE ALL MAINTENANCE PERSONNEL ON A CONTINUOUS BASIS OF THE PRESENCE OF RECYCLED WATER. PERSONNEL MUST BE INFORMED THAT RECYCLED WATER IS MEANT FOR IRRIGATION PURPOSES ONLY, AND IS NOT APPROVED FOR DRINKING PURPOSES, HAND WASHING, CLEANING OF TOOLS, ETC. GIVEN THE HIGH TURNOVER RATE OF EMPLOYEES IN THE LANDSCAPE INDUSTRY, IT IS IMPORTANT THIS INFORMATION BE DISSEMINATED ON AN ALMOST DAILY BASIS.
27. NON-DESIGNATED USE AREAS SHALL BE PROTECTED FROM CONTACT WITH RECYCLED WATER, WHETHER BY WINDBLOWN SPRAY OR BY DIRECT APPLICATION THROUGH IRRIGATION OR OTHER USE. LACK OF PROTECTION, WHETHER BY DESIGN, CONSTRUCTION PRACTICE OR SYSTEM OPERATION, IS STRICTLY PROHIBITED.

## IRRIGATION SCHEDULE

SYMBOL	MANUFACTURER/MODEL/DESCRIPTION	PSI	DETAIL
	HUNTER MP1000 PROS-06-PRS40-CV-R TURF ROTATOR, 6" (15.24 CM) POP-UP WITH CHECK VALVE, RECLAIMED BODY CAP. PRESSURE REGULATED TO 40 PSI (2.76 BAR), MP ROTATOR NOZZLE ON PRS40 BODY. M=MARKON ADJ ARC 90 TO 210, L=LIGHT BLUE 210 TO 270 ARC, O=OLIVE 360 ARC.	40	OIL-3.2
	HUNTER MP2000 PROS-06-PRS40-CV-R TURF ROTATOR, 6" (15.24 CM) POP-UP WITH CHECK VALVE, RECLAIMED BODY CAP. PRESSURE REGULATED TO 40 PSI (2.76 BAR), MP ROTATOR NOZZLE ON PRS40 BODY. K=BLACK ADJ ARC 90-210, G=GREEN ADJ ARC 210-270, R=RED 360 ARC.	40	OIL-3.2
	HUNTER MP3000 PROS-06-PRS40-CV-R TURF ROTATOR, 6" (15.24 CM) POP-UP WITH FACTORY INSTALLED CHECK VALVE, RECLAIMED BODY CAP. PRESSURE REGULATED TO 40 PSI (2.76 BAR), MP ROTATOR NOZZLE ON PRS40 BODY. B=BLUE ADJ ARC 90-210, Y=YELLOW ADJ ARC 210-270, A=GRAY 360 ARC.	40	OIL-3.2
	HUNTER MP800SR PROS-06-PRS40-CV-R TURF ROTATOR, 6.0" POP-UP WITH CHECK VALVE. PRESSURE REGULATED TO 40 PSI (2.76 BAR), MP ROTATOR NOZZLE ON PRS40 BODY. ADJ=ORANGE AND GRAY (ARC 90-210), 360=LIME GREEN AND GRAY (ARC 360)	40	OIL-3.2
	HUNTER MP CORNER PROS-06-PRS40-CV-R TURF ROTATOR, 6" (15.24 CM) POP-UP WITH FACTORY INSTALLED CHECK VALVE, RECLAIMED BODY CAP. PRESSURE REGULATED TO 40 PSI (2.76 BAR), MP ROTATOR NOZZLE ON PRS40 BODY. T=TURQUOISE ADJ ARC 45-105.	40	OIL-3.2
	HUNTER MP1000 PROS-12-PRS40-CV-R SHRUB ROTATOR, 12" (30.48 CM) POP-UP WITH CHECK VALVE, PURPLE CAP. PRESSURE REGULATED TO 40 PSI (2.76 BAR), MP ROTATOR NOZZLE. M=MARKON ADJ ARC 90 TO 210, L=LIGHT BLUE 210 TO 270) ARC, O=OLIVE 360 ARC ON PRS40 BODY.	40	OIL-3.2
	HUNTER MP2000 PROS-12-PRS40-CV-R SHRUB ROTATOR, 12" (30.48 CM) POP-UP WITH FACTORY INSTALLED CHECK VALVE, RECLAIMED BODY CAP. PRESSURE REGULATED TO 40 PSI (2.76 BAR), MP ROTATOR NOZZLE. K=BLACK ADJ ARC 90-210, G=GREEN ADJ ARC 210-270, R=RED 360 ARC ON PRS40 BODY.	40	OIL-3.2
	HUNTER MP800SR PROS-12-PRS40-CV-R SHRUB ROTATOR, 12" (30.48 CM) POP-UP WITH CHECK VALVE, RECLAIMED PURPLE BODY CAP. PRESSURE REGULATED TO 40 PSI (2.76 BAR), MP ROTATOR NOZZLE. OR = ORANGE ADJ ARC 90 TO 210.	40	OIL-3.2
	HUNTER MP CORNER PROS-12-PRS40-CV-R SHRUB ROTATOR, 12" (30.48 CM) POP-UP WITH CHECK VALVE, PURPLE CAP. PRESSURE REGULATED TO 40 PSI (2.76 BAR), MP ROTATOR NOZZLE. T=TURQUOISE ADJ ARC 45-105 ON PRS40 BODY.	40	OIL-3.2
	HUNTER MP STRIP PROS-12-PRS40-CV-R SHRUB ROTATOR, 12" (30.48 CM) POP-UP WITH FACTORY INSTALLED CHECK VALVE, RECLAIMED BODY CAP. PRESSURE REGULATED TO 40 PSI (2.76 BAR), MP ROTATOR NOZZLE. L=STAINLESS LEFT STRIP, SST=BRONZE SIDE STRIP, R=COPPER RIGHT STRIP ON PRS40 BODY.	40	OIL-3.2
	RAIN BIRD 1812-SAM-5 SERIES STREAM W/ PCS STREAM BUBBLER 12.0" POP UP WITH CHECK VALVE AND PRESSURE COMPENSATING SCREEN.	30	NLI-3.2
	RAIN BIRD KCZF-100-PRF MEDIUM FLOW DRIP CONTROL KIT. 1" DV VALVE WITH 1" PRESSURE REGULATING FILTER AT 40PSI, AND MDGF FITTING. 3GPM-15GPM.		R/LI-3.2
	RAIN BIRD KCZ-150-PRB-COM HIGH FLOW CONTROL ZONE KIT. FOR LARGE COMMERCIAL DRIP ZONES. 1-1/2" PESB VALVE WITH TWO 1" PRESSURE REGULATING (40PSI) QUICK-CHECK BASKET FILTERS. FLOW RANGE: 15-40GPM.		R/LI-3.2
	RAIN BIRD MDCFFCAP DRIPLINE FLUSH VALVE PURPLE CAP IN COMPRESSION FITTING COUPLER. FOR NON-POTABLE WATER USE.		S/LI-3.2
	RAIN BIRD ARV050 1/2" AIR RELIEF VALVE, MADE OF QUALITY RUST-PROOF MATERIALS. WITH A 6.0" DRIP VALVE BOX (SEB 7X8 EMITTER BOX). USE WITH INSTALLATION BELOW SOIL. THE VALVE WILL ALLOW AIR TO ESCAPE THE PIPELINE, THUS PREVENTING WATER HAMMER OR BLOCKAGE.		T/LI-3.2
	RAIN BIRD OPERIND DRIP SYSTEM OPERATION INDICATOR. STEM RISES 6" FOR CLEAR VISIBILITY WHEN DRIP SYSTEM IS CHARGED TO A MINIMUM OF 20PSI. INCLUDES 16" OF 1/4" DISTRIBUTION TUBING WITH CONNECTION FITTING PRE-INSTALLED.		U/LI-3.2
	AREA TO RECEIVE DRIPLINE RAIN BIRD XFS-P-06-12 (12) XFS SUB-SURFACE PRESSURE COMPENSATING LANDSCAPE DRIPLINE W/COPPER SHIELD TECHNOLOGY. 0.6GPH EMITTERS AT 12.0" O.C. DRIPLINE LATERALS SPACED AT 12.0" APART, WITH EMITTERS OFFSET FOR TRIANGULAR PATTERN. PURPLE TUBING FOR NON-POTABLE WATER.		V/LI-3.2 W,X,Y/LI-3.3

SYMBOL	MANUFACTURER/MODEL/DESCRIPTION	DETAIL
	RAIN BIRD PPSBR-PRS-D ELECTRIC REMOTE CONTROL VALVE FOR RECLAIMED WATER APPLICATIONS WITH SCRUBBER MECHANISM AND PRESSURE REGULATOR.	F/LI-3.1
	NELSON #7645 QUICK COUPLER VALVE, RED BRASS, ACME THREAD WITH PURPLE LOCKING COVER WITH NELSON #7641 QUICK COUPLER VALVE KEY, RED BRASS ACME THREAD, WITH HOSE SWIVEL	G/LI-3.1
	NIBCO T-580-S6-R-66-LL STAINLESS STEEL BALL VALVE SHUT OFF VALVE FOR REMOTE CONTROL VALVE MANIFOLDS, SAME SIZE AS MAINLINE PIPE UPSTREAM OF MANIFOLD	E/LI-3.1
	SUPERIOR 950-200-DW-HB-RW 2" 2" MASTER VALVE, NORMALLY CLOSED	C/LI-3.1
	CALSENSE ET2000E ET2000E-48-EN-FL-RRE-SSE-RFM2B IN STAINLESS STEEL ENCLOSURE	A/LI-3.1
	CALSENSEFM1.5B FM-1.5B INCLUDED IN CONTROLLER ASSEMBLY	B/LI-3.1
	RECYCLED WATER SIGN	M/LI-3.2
	POINT OF CONNECTION 6"	-
	POINT OF CONNECTION 6"	-
	IRRIGATION LATERAL LINE: PVC SCHEDULE 40 AND CLASS 315 PVC SCHEDULE 40 TO 1-1/2", PVC CLASS 315 SDR 13.5 FOR PIPES 2" AND LARGER. ONLY LATERAL TRANSITION PIPE SIZES 1" AND ABOVE ARE INDICATED ON THE PLAN, WITH ALL OTHERS BEING 3/4" IN SIZE.	L/LI-3.1
	IRRIGATION MAINLINE: PVC SCHEDULE 40 AND CLASS 315 PVC SCHEDULE 40 TO 1-1/2", PVC CLASS 315 SDR 13.5 FOR PIPES 2" AND LARGER.	L/LI-3.1
	PIPE SLEEVE: PVC SCHEDULE 40 AND CLASS 315 TYPICAL PIPE SLEEVE FOR IRRIGATION PIPE. PIPE SLEEVE SIZE SHALL ALLOW FOR IRRIGATION PIPING AND THEIR RELATED COUPLINGS TO EASILY SLIDE THROUGH SLEEVING MATERIAL. EXTEND SLEEVES 18 INCHES BEYOND EDGES OF PAVING OR CONSTRUCTION.	K/LI-3.1

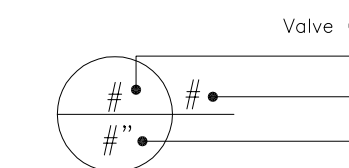

## SPECIAL NOTES FOR MIRAMAR COLLEGE:

THE FOLLOWING NOTES PROVIDED BY THE DISTRICT FOR CONTRACTOR REFERENCE:

- CAUTION:**
1. THE CONTRACTOR MAY ENCOUNTER OLD MILITARY ORDNANCE. THE CONTRACTOR SHALL NOTIFY THE DISTRICT IMMEDIATELY IF THEY ENCOUNTER ANY ORDNANCE.
  2. GEOTECHNICAL INVESTIGATIONS FOR THE SURROUNDING IMPROVEMENTS DESCRIBE THE SURROUNDING SOILS AS SANDY CLAY OVER HIGHLY CEMENTED GRAVEL AND COBBLE CONGLOMERATE (LINDA VISTA FORMATION AND STADIUM CONGLOMERATE). NO GROUNDWATER WAS ENCOUNTERED. TRENCHING INTO THE LINDA VISTA FORMATION AND STADIUM CONGLOMERATE WILL BE DIFFICULT AND MAY REQUIRE HEAVY EQUIPMENT.

## CITY OF SAN DIEGO WATER PRESSURE ZONES:

1) EXISTING RECYCLED WATER MAIN ON HILLERY DRIVE IS RECYCLED WATER PRESSURE ZONE No. 890 (ALL IRRIGATION SHOWN ON THESE PLANS IS RECYCLED WATER FROM THIS ZONE).

2) EXISTING POTABLE WATER IS PRESSURE ZONE No. 712.

CITY OF SAN DIEGO  
WORK ORDER No. XX

## WYAC PROJECT #12-003.001

APPROVED BY	APPROVED BY	DRAWN LE	IRRIGATION SCHEDULE AND NOTES	DATE SEPTEMBER 12, 2017	
		CHECKED BH		MIRAMAR COLLEGE INFRASTRUCTURE AND SITE DEVELOPMENT PHASE II ( SOUTH) SCOPE "B"	SHEET 24
LANDSCAPE ARCHITECT OF WORK PATRICK CAUGHEY EXP. 08-21-16	D.S.A.	REVISION 		SAN DIEGO COMMUNITY COLLEGE DISTRICT	LI-2.1 OF 46

Wimmer  
Yamada  
and  
Caughey

Landscape Architecture | Environmental Planning  
3067 Fifth Avenue, San Diego, California 92103-0540  
760-323-6114 | 760-323-0640 | www.wyac.com

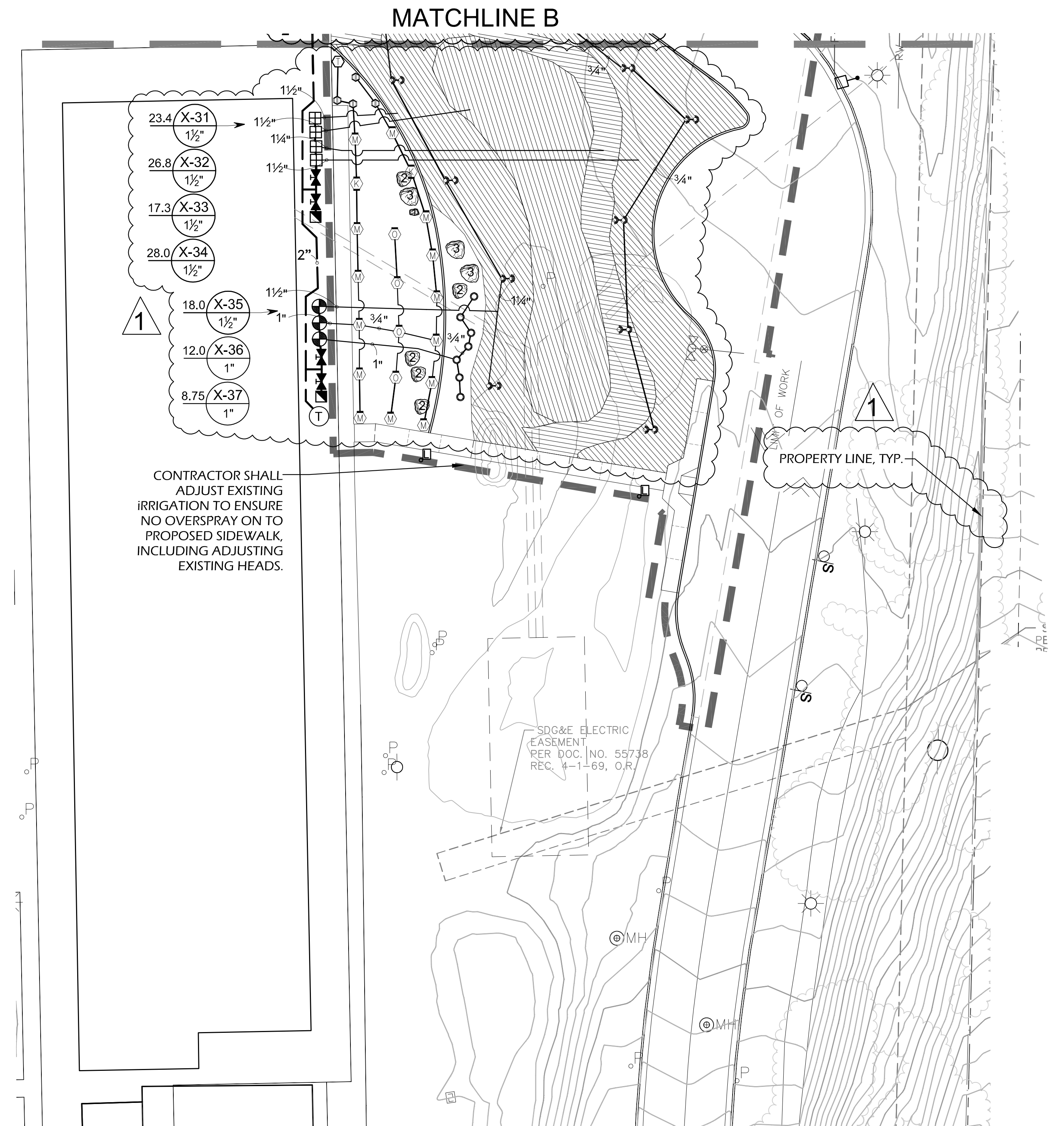
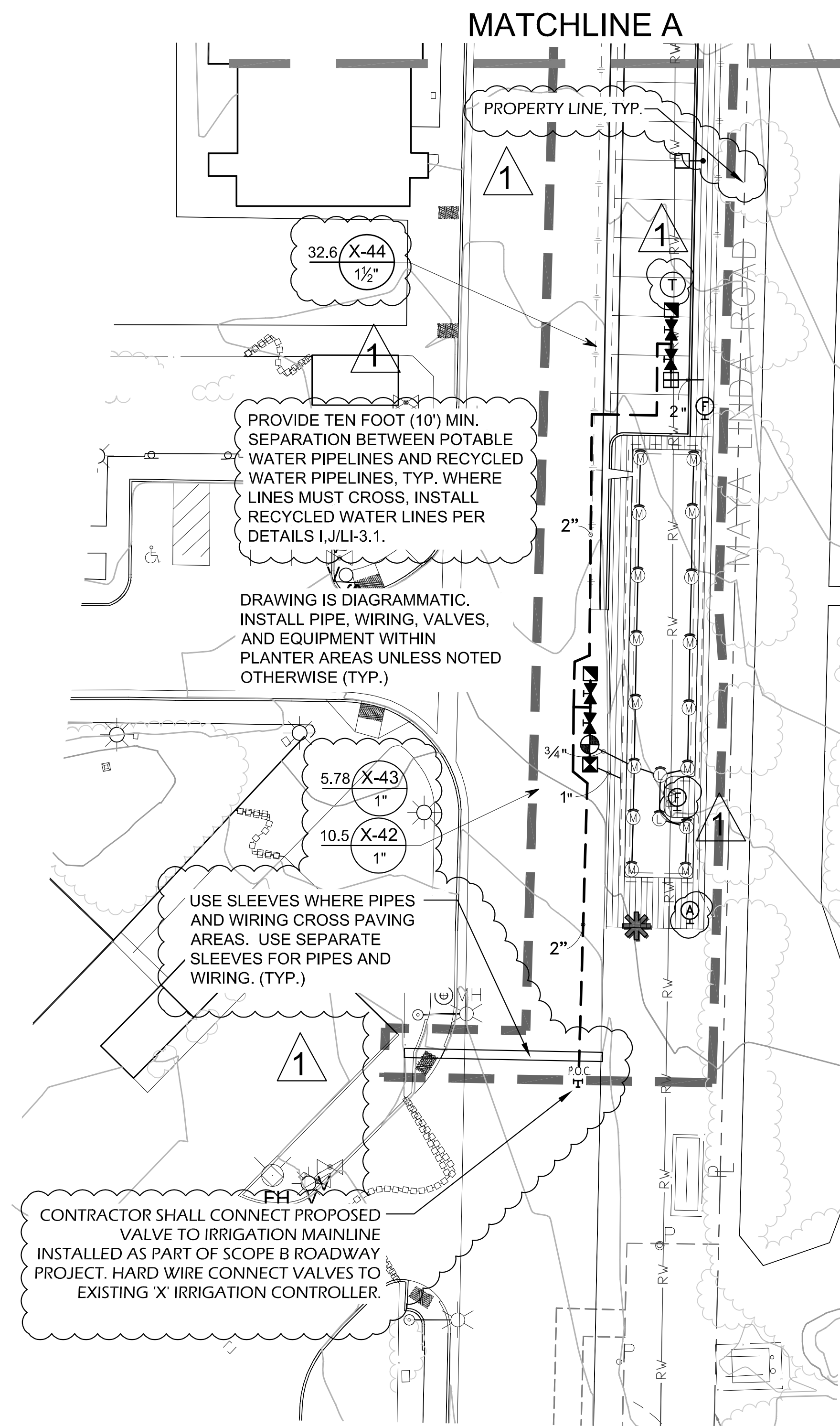
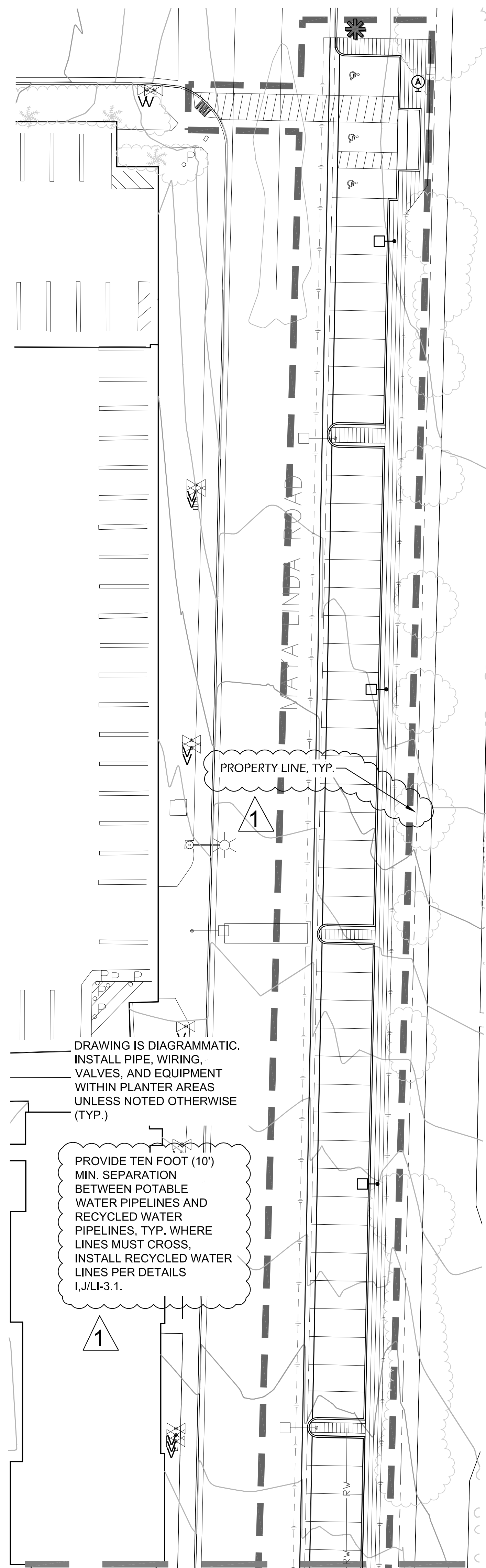

**SPECIAL NOTES FOR MIRAMAR COLLEGE:**  
THE FOLLOWING NOTES PROVIDED BY THE DISTRICT FOR CONTRACTOR REFERENCE:

**CAUTION:**  
1. THE CONTRACTOR MAY ENCOUNTER OLD MILITARY ORDNANCE. THE CONTRACTOR SHALL NOTIFY THE DISTRICT IMMEDIATELY IF THEY ENCOUNTER ANY ORDNANCE.

2. GEOTECHNICAL INVESTIGATIONS FOR THE SURROUNDING IMPROVEMENTS DESCRIBE THE UNDERLYING SOILS AS SANDY CLAY OVER HIGHLY CEMENTED GRAVEL AND COBBLE CONGLOMERATE (LINDA VISTA FORMATION AND STADIUM CONGLOMERATE). NO GROUNDWATER WAS ENCOUNTERED. TRENCHING INTO THE LINDA VISTA FORMATION AND STADIUM CONGLOMERATE WILL BE DIFFICULT AND MAY REQUIRE HEAVY EQUIPMENT.

SEE SHEET LI-2.1 FOR IRRIGATION SCHEDULE AND NOTES.  
SEE SHEETS LI-3.1 AND LI-3.2 FOR IRRIGATION DETAILS AND CALCULATIONS.

**CITY OF SAN DIEGO WATER PRESSURE ZONES:**

1) EXISTING RECYCLED WATER MAIN ON HILLERY DRIVE IS RECYCLED WATER PRESSURE ZONE No. 890 (ALL IRRIGATION SHOWN ON THESE PLANS IS RECYCLED WATER FROM THIS ZONE).

2) EXISTING POTABLE WATER IS PRESSURE ZONE No. 712.

CITY OF SAN DIEGO  
WORK ORDER No. 539264

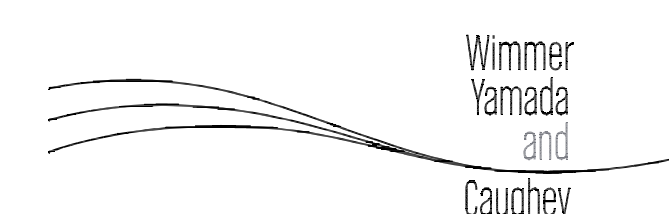
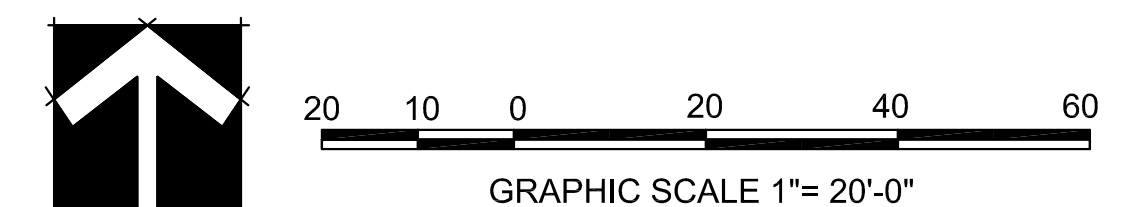
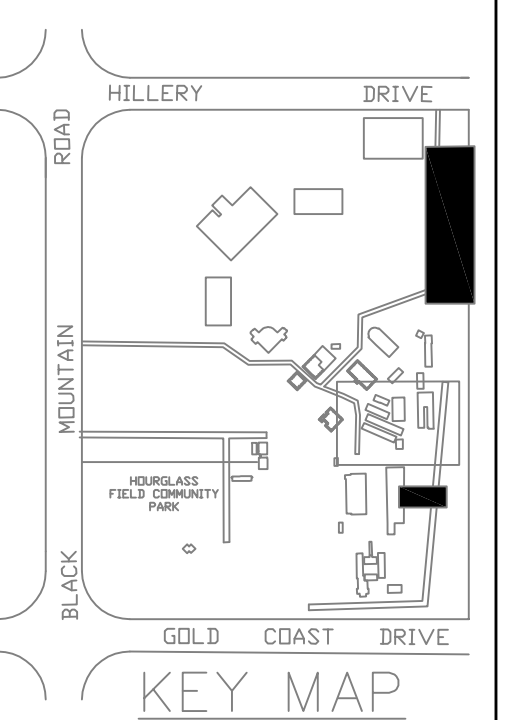

9067 Fifth Avenue, San Diego, California 92121-0110  
760-333-4014 / 619-333-0640 www.wyca.com

WYAC PROJECT #12-003.001

<p>LANDSCAPE ARCHITECT OF WORK PATRICK CAUGHEY EXP. 08-31-16</p>	APPROVED BY	APPROVED BY	DRAWN	<p><b>IRRIGATION PLAN</b></p> <p>MIRAMAR COLLEGE INFRASTRUCTURE AND SITE DEVELOPMENT PHASE II ( SOUTH ) SCOPE "B"</p> <p>SAN DIEGO COMMUNITY COLLEGE DISTRICT</p>		DATE
			CHECKED			SHEET
			REVISION			LI-1.1
						OF 44

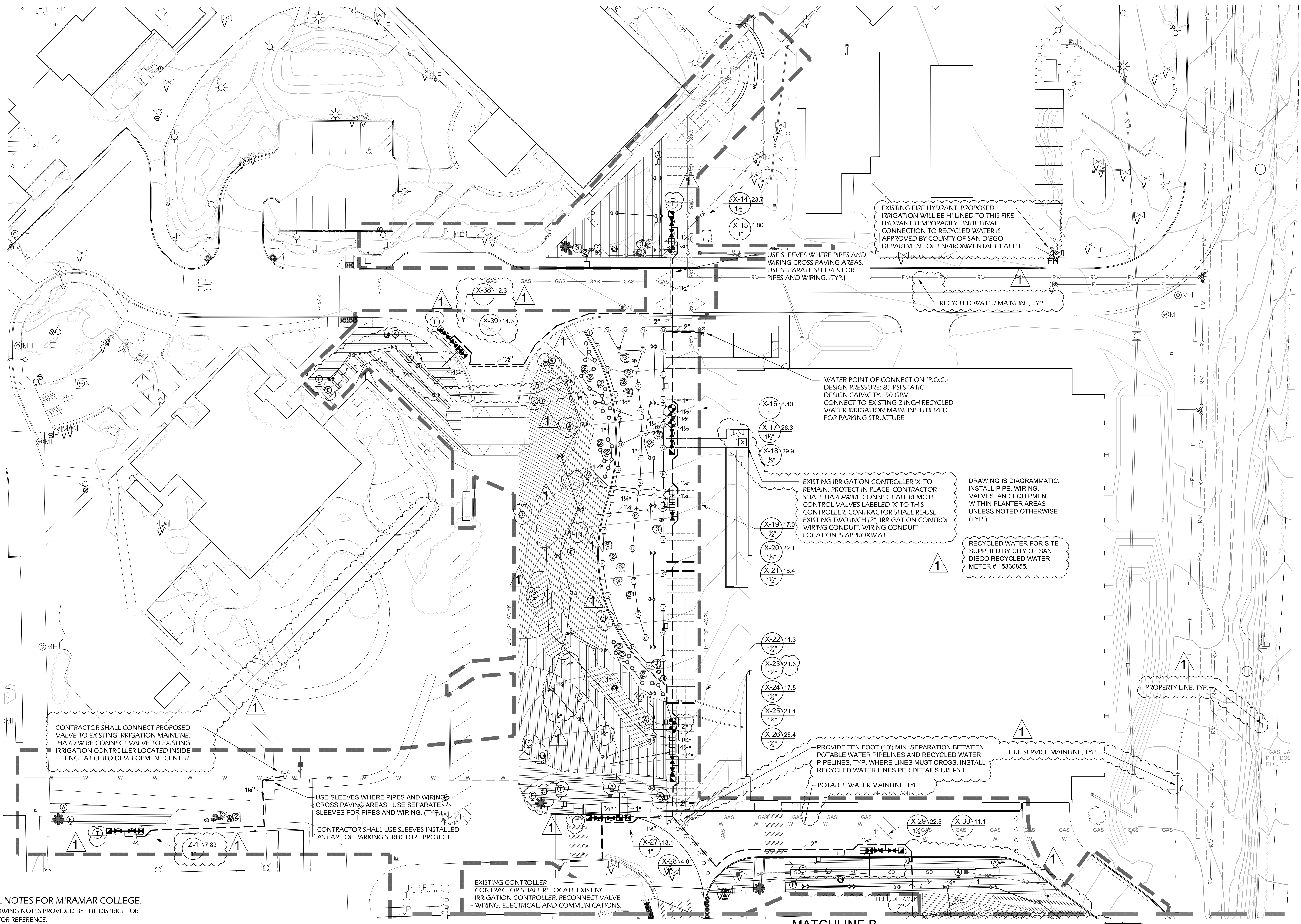

EXISTING FIRE HYDRANT. PROPOSED IRRIGATION WILL BE HI-LINED TO THIS FIRE HYDRANT TEMPORARILY UNTIL FINAL CONNECTION TO RECYCLED WATER IS APPROVED BY COUNTY OF SAN DIEGO DEPARTMENT OF ENVIRONMENTAL HEALTH.

USE SLEEVES WHERE PIPES AND WIRING CROSS PAVING AREAS. USE SEPARATE SLEEVES FOR PIPES AND WIRING. (TYP.)

RECYCLED WATER MAINLINE, TYP.

WATER POINT-OF-CONNECTION (P.O.C.)  
DESIGN PRESSURE: 85 PSI STATIC  
DESIGN CAPACITY: 50 GPM  
CONNECT TO EXISTING 2-INCH RECYCLED WATER IRRIGATION MAINLINE UTILIZED FOR PARKING STRUCTURE.

EXISTING IRRIGATION CONTROLLER 'X' TO REMAIN, PROTECT IN PLACE. CONTRACTOR SHALL HARD-WIRE CONNECT ALL REMOTE CONTROL VALVES LABELED 'X' TO THIS CONTROLLER. CONTRACTOR SHALL RE-USE EXISTING TWO INCH (2") IRRIGATION CONTROL WIRING CONDUIT. WIRING CONDUIT LOCATION IS APPROXIMATE.

DRAWING IS DIAGRAMMATIC. INSTALL PIPE, WIRING, VALVES, AND EQUIPMENT WITHIN PLANTER AREAS UNLESS NOTED OTHERWISE (TYP.)

RECYCLED WATER FOR SITE SUPPLIED BY CITY OF SAN DIEGO RECYCLED WATER METER # 15330855.

CONTRACTOR SHALL CONNECT PROPOSED VALVE TO EXISTING IRRIGATION MAINLINE. HARD WIRE CONNECT VALVE TO EXISTING IRRIGATION CONTROLLER LOCATED INSIDE FENCE AT CHILD DEVELOPMENT CENTER.

USE SLEEVES WHERE PIPES AND WIRING CROSS PAVING AREAS. USE SEPARATE SLEEVES FOR PIPES AND WIRING. (TYP.)

CONTRACTOR SHALL USE SLEEVES INSTALLED AS PART OF PARKING STRUCTURE PROJECT.

PROVIDE TEN FOOT (10') MIN. SEPARATION BETWEEN POTABLE WATER PIPELINES AND RECYCLED WATER PIPELINES, TYP. WHERE LINES MUST CROSS, INSTALL RECYCLED WATER LINES PER DETAILS I.JULI-3.1.

POTABLE WATER MAINLINE, TYP.

FIRE SERVICE MAINLINE, TYP.

PROPERTY LINE, TYP.

**SPECIAL NOTES FOR MIRAMAR COLLEGE:**  
THE FOLLOWING NOTES PROVIDED BY THE DISTRICT FOR CONTRACTOR REFERENCE:

**CAUTION:**  
1. THE CONTRACTOR MAY ENCOUNTER OLD MILITARY ORDNANCE. THE CONTRACTOR SHALL NOTIFY THE DISTRICT IMMEDIATELY IF THEY ENCOUNTER ANY ORDNANCE.

2. GEOTECHNICAL INVESTIGATIONS FOR THE SURROUNDING IMPROVEMENTS DESCRIBE THE UNDERLYING SOILS AS SANDY CLAY OVER HIGHLY CEMENTED GRAVEL AND COBBLE CONGLOMERATE (LINDA VISTA FORMATION AND STADIUM CONGLOMERATE). NO GROUNDWATER WAS ENCOUNTERED. TRENCHING INTO THE LINDA VISTA FORMATION AND STADIUM CONGLOMERATE WILL BE DIFFICULT AND MAY REQUIRE HEAVY EQUIPMENT.

**SEE SHEET LI-2.1 FOR IRRIGATION SCHEDULE AND NOTES.  
SEE SHEETS LI-3.1 AND LI-3.2 FOR IRRIGATION DETAILS AND CALCULATIONS.**

**CITY OF SAN DIEGO WATER PRESSURE ZONES:**

- 1) EXISTING RECYCLED WATER MAIN ON HILLERY DRIVE IS RECYCLED WATER PRESSURE ZONE No. 890 (ALL IRRIGATION SHOWN ON THESE PLANS IS RECYCLED WATER FROM THIS ZONE).
- 2) EXISTING POTABLE WATER IS PRESSURE ZONE No. 712.

CITY OF SAN DIEGO  
WORK ORDER No. 539264

Wimmer  
Yamada  
and  
Caughy  
Landscape Architecture | Environmental Planning  
3007 Fifth Avenue, San Diego, California 92103-1540  
1-619-232-0010 | 619-232-0640 | www.wyac.com

WYAC PROJECT #12-003.001

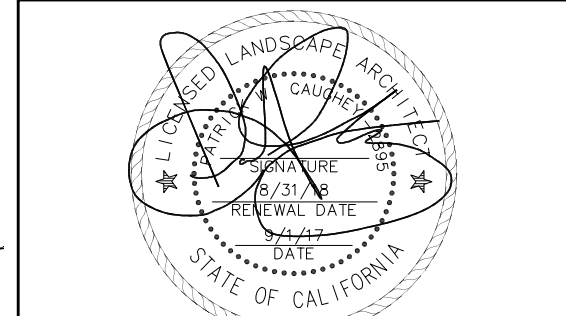

PATRICK CAUGHY  
EXP. 08-31-16

APPROVED BY  
D.S.A.

APPROVED BY  
DISTRICT ARCHITECT

DRAWN  
LE  
CHECKED  
BH  
REVISION

**IRRIGATION PLAN**  
MIRAMAR COLLEGE  
INFRASTRUCTURE AND SITE  
DEVELOPMENT PHASE II ( SOUTH )  
SCOPE "B"  
SAN DIEGO COMMUNITY COLLEGE DISTRICT

DATE  
SEPTEMBER 1, 2017  
SHEET  
LI-1.2  
OF  
44

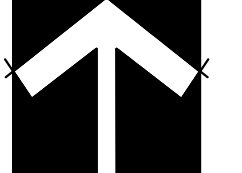

GRAPHIC SCALE 1" = 20'-0"

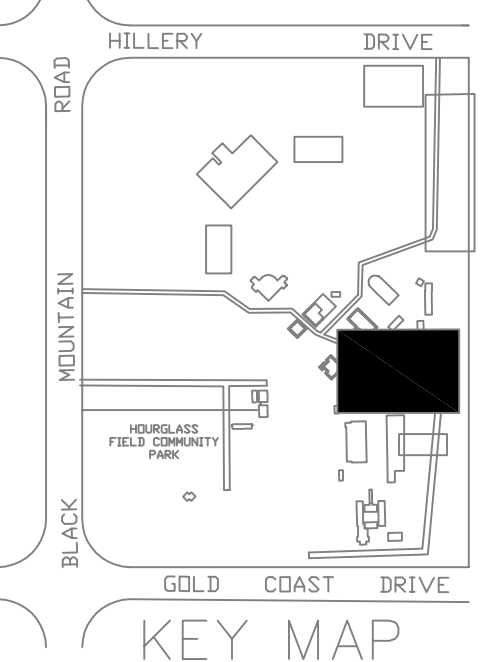

## IRRIGATION NOTES:

- THE SPRINKLER SYSTEM DESIGN IS BASED ON THE MINIMUM STATIC PRESSURE OF 85 PSI, AND THE MAXIMUM FLOW DEMAND OF 50 GPM AT THE WATER POINT OF CONNECTION (P.O.C.). THE IRRIGATION CONTRACTOR SHALL VERIFY WATER PRESSURE PRIOR TO CONSTRUCTION AND SHALL REPORT ANY DIFFERENCES BETWEEN THE DESIGN WATER PRESSURE AND THE ACTUAL WORKING PRESSURE READING AT THE IRRIGATION P.O.C. TO OWNER'S REPRESENTATIVE.
- THIS DESIGN IS DIAGRAMMATIC. THESE DRAWINGS ARE INTENDED TO BE A SCHEMATIC REPRESENTATION OF THE FINISHED IRRIGATION SYSTEM. ALL PIPING, VALVES, ETC. SHOWN WITHIN PAVED AREAS ARE FOR DESIGN CLARIFICATION ONLY AND SHALL BE INSTALLED IN PLANTING AREAS WHERE POSSIBLE. AVOID ANY CONFLICTS BETWEEN THE IRRIGATION SYSTEM, PLANTING, AND ARCHITECTURAL FEATURES. CONTRACTOR SHALL MAKE ALL NECESSARY FIELD ADJUSTMENTS TO ACCOMMODATE ACTUAL SITE CONDITIONS.
- CONTRACTOR TO VERIFY ALL CONDITIONS AND DIMENSIONS SHOWN ON THESE PLANS AT THE SITE PRIOR TO COMMENCEMENT OF WORK.
- CONTRACTOR SHALL NOT WILLFULLY INSTALL THE IRRIGATION SYSTEM AS SHOWN ON THESE DRAWINGS WHEN IT IS OBVIOUS THAT FIELD OBSTRUCTIONS AND/OR DIFFERENCES IN THE AREA DIMENSIONS EXIST THAT MAY NOT HAVE BEEN CONSIDERED IN THE SYSTEM ENGINEERING. SUCH OBSTRUCTIONS OR DIFFERENCES SHALL BE BROUGHT TO THE IMMEDIATE ATTENTION OF THE OWNER'S REPRESENTATIVE. IN THE EVENT THAT THIS NOTIFICATION IS NOT GIVEN, THE CONTRACTOR SHALL ASSUME FULL RESPONSIBILITY FOR ANY REVISIONS NECESSARY.
- CONTRACTOR TO COORDINATE SLEEVING UNDER ALL PAVING WITH OTHER TRADES AS NECESSARY. NO TEES OR ELLS SHALL BE INSTALLED UNDER PAVING. ALL SLEEVES SHALL EXTEND A MINIMUM OF TWENTY-FOUR INCHES (24") BEYOND EDGE OF PAVING. ALL SLEEVING LOCATED UNDER PAVING SHALL BE TWO (2) TIMES THE OUTSIDE DIAMETER OF THE PIPE TO BE SLEEVED, MINIMUM TWO-INCH (2") DIAMETER. CONTRACTOR TO INSTALL METALLIC BACKED TAPE ALONG THE ENTIRE LENGTH OF THE SLEEVE, TWELVE INCHES (12") DIRECTLY ABOVE THE SLEEVE. TAPE SHALL BE MARKED "IRRIGATION" IN TWO INCH (2") CAPITAL LETTERS EVERY THREE FEET ALONG THE TAPE.
- REMOTE CONTROL VALVES SHALL BE INSTALLED ADJACENT TO WALKWAYS UNLESS OTHERWISE NOTED.
- CONCRETE THRUST BLOCKS SHALL BE USED ON ALL IRRIGATION MAINLINES WHERE CHANGES OF DIRECTION OF FORTY-FIVE (45) DEGREES OR MORE SHOULD OCCUR.
- WHERE TREES, LIGHT STANDARDS, ETC., ARE AN OBSTRUCTION TO IRRIGATION COVERAGE, THEN PIPING AND SPRINKLER HEADS SHALL BE ADJUSTED AND/OR RELOCATED AS NECESSARY TO OBTAIN FULL COVERAGE AND MINIMUM OVERSPRAY. DO NOT EXCEED SPACING AS PER MANUFACTURER'S RECOMMENDATIONS.
- CONTRACTOR SHALL FLUSH ALL MAIN LINES PRIOR TO INSTALLATION OF THE VALVES, AND SHALL FLUSH ALL LATERAL LINES PRIOR TO INSTALLATION OF THE SPRINKLER HEADS.
- CONTRACTOR SHALL FINE-TUNE AND ADJUST ALL SPRINKLER SYSTEMS TO ACHIEVE OPTIMUM PERFORMANCE AND COMPLETE COVERAGE, WITH MINIMUM OVERSPRAY ONTO HARDSCAPE AREAS. THIS INCLUDES ADJUSTMENT OF THE FLOW CONTROL STEM AT EACH REMOTE CONTROL VALVE TO OBTAIN THE OPTIMUM OPERATING FLOW // PRESSURE FOR THAT SYSTEM, AND ADJUSTMENT OF ALL SPRINKLER NOZZLES.
- COORDINATE IRRIGATION WORK WITH PLANTING PLANS TO AVOID CONFLICTING LOCATIONS BETWEEN PIPING AND PLANT PITS. SPECIMEN TREE LOCATIONS TAKE PRECEDENCE OVER IRRIGATION PIPING. LOCATE SPECIMEN TREES PRIOR TO TRENCHING FOR IRRIGATION PIPING.
- ALL LATERAL END RUNS ARE AS PER CONTRACT DOCUMENTS.
- TRENCH MARKER: ALL DIRECT BURIAL WIRES SHALL BE MARKED WITH A CONTINUOUS RED COLORED TRENCH MARKER TAPE PLACED NINE INCHES (9") BELOW FINISH GRADE DIRECTLY ABOVE THE BURIED WIRES. MARKER TAPE SHALL BE EQUAL TO "ALAMA TAPE" AS MANUFACTURED BY PAUL POTTER WARNING TAPE INC. TAPE SHALL BE FOUR INCHES (4") WIDE.
- IRRIGATION SYSTEMS ARE TO BE INSTALLED AS DESIGNED AND IN ACCORDANCE WITH THE CRITERIA AND APPLICABLE STANDARDS AS OF THE APPROVED DATE OF THESE PLANS. ALL IRRIGATION SYSTEM COMPONENTS SHALL BE INSTALLED PER LOCAL CODE. CONTRACTORS SHALL SECURE ALL NECESSARY PERMITS.
- FOR REMOTE CONTROL VALVE MANIFOLDS, BALL VALVE SIZE SHALL EQUAL THE SIZE OF THE LARGEST REMOTE CONTROL VALVE IN THE MANIFOLD.
- PROVIDE PULL BOXES FOR CONTROL WIRING AT ALL CHANGES IN DIRECTION GREATER THAN FORTY-FIVE (45) DEGREES AND WHERE WIRE RUNS EXCEED THREE HUNDRED FEET (300') IN LENGTH. IN-LINE WIRE SPLICES SHALL BE MADE ONLY IN PULL BOXES, WITH WATERPROOF CONNECTORS.
- CONTRACTOR SHALL PROVIDE ONE (1) SET OF EXTRA CONTROL WIRES PER MANIFOLD.
- BACKFILL MATERIAL SHALL BE CLEAN AND FREE OF DEBRIS, ROCKS LARGER THAN ONE INCH (1"), AND OBJECTS WITH SHARP EDGES.
- CONTRACTOR SHALL INSTALL IN-LINE ANTI-DRAIN VALVES AS WARRANTED BY SITE CONDITIONS TO ALLEVIATE LOW-HEAD DRAINAGE.

## RECYCLED WATER NOTES:

- TWO WORKING DAYS PRIOR** TO COMMENCEMENT OF ANY EXCAVATION ON SITE IMPROVEMENTS, CONTRACTOR SHALL NOTIFY CITY OF SAN DIEGO, PUBLIC UTILITIES DEPARTMENT, RECYCLED WATER SECTION AT **619.533.4259**.
  - ALL WORK SHALL BE DONE IN ACCORDANCE WITH THE CITY OF SAN DIEGO RULES AND REGULATIONS FOR RECYCLED WATER USE AND DISTRIBUTION WITHIN THE CITY OF SAN DIEGO AND THE COUNTY OF SAN DIEGO DEPARTMENT OF ENVIRONMENTAL HEALTH REQUIREMENTS.
  - ALL BACKFLOW PREVENTER INSTALLATIONS AND LOCATIONS SHALL BE SUBJECT TO APPROVAL BY THE CITY OF SAN DIEGO PUBLIC UTILITIES DEPARTMENT.
  - ALL PUBLIC FACILITIES SUCH AS COMFORT STATIONS, DRINKING FOUNTAINS, ETC. SHALL BE PROTECTED FROM SPRAY AND/OR MISTING BY RECYCLED WATER.
  - NO PONDING, RUN-OFF OR OVER-SPRAY IS PERMITTED. ADJUST ALL SPRINKLER HEADS TO PREVENT OVER SPRAYING ONTO SIDEWALKS, STREETS AND PRIVATE LOTS.
  - HOSE BIBS ON RECYCLED WATER SYSTEMS ARE PROHIBITED IN PUBLIC AREAS. ALL POTABLE HOSE BIBS ONSIGHT MUST BE PROTECTED BY A HOSE BIB VACUUM BREAKER.
  - CROSS CONNECTION BETWEEN RECYCLED WATER LINES AND POTABLE IS STRICTLY PROHIBITED.
  - QUICK COUPLING VALVES USED IN RECYCLED WATER SYSTEMS SHALL CONFORM TO THE FOLLOWING:
    - A TYPE APPROVED FOR RECYCLED WATER USE WITH A NORMAL WORKING PRESSURE OF 150 P.S.I.
    - RECYCLED WATER QUICK COUPLER MUST BE DIFFERENT FROM POTABLE WATER QUICK COUPLER VALVES.
    - IN ORDER TO PREVENT UNAUTHORIZED USE, THE VALVE SHALL BE OPERATED ONLY WITH A SPECIAL COUPLER KEY THAT DIFFERS FROM THE POTABLE KEY FOR OPENING AND CLOSING THE VALVE.
    - THE COVER SHALL BE PERMANENTLY ATTACHED TO THE QUICK COUPLING VALVES. IT SHALL BE PURPLE RUBBER OR VINYL.
    - LOCKING COVERS ARE REQUIRED.
  - NO SUBSTITUTION OF PIPE MATERIALS WILL BE ALLOWED WITHOUT PRIOR APPROVAL BY THE CITY OF SAN DIEGO.
  - INSTALL APPROVED, METALLIC BACKED AND STENCILED WARNING TAPE OVER ALL PRESSURE RECYCLED WATER LINES. STENCIL AND COLOR CODE (PURPLE PANTONE 522) ALL IRRIGATION PIPE. ORIENT THE STENCILING TO THE TOP OF THE TRENCH.
  - PROVIDE A MINIMUM OF AT LEAST 18 INCHES OF COVERING OVER ALL WIRING AND PIPING.
  - OPERATE THE IRRIGATION SYSTEM ONLY BETWEEN 9:00 PM AND 6:00 AM, UNLESS THE CERTIFIED SITE SUPERVISOR IS PRESENT AT THE SITE DURING THE IRRIGATION PERIOD.
  - WHEN POTABLE WATER LINES AND RECYCLED WATER LINES CROSS, THE RECYCLED LINE SHALL BE INSTALLED WITHIN A PROTECTIVE SLEEVE. THE SLEEVE SHALL EXTEND 10 FEET FROM EACH SIDE, FROM THE CENTER LINE OF POTABLE LINE, FOR A TOTAL OF 20 FEET.
  - MAINTAIN A 10 FOOT HORIZONTAL SEPARATION BETWEEN POTABLE WATER AND RECYCLED WATER OR SEWER LINES. INSTALL SEWER LINE BELOW RECYCLED WATER LINE AND RECYCLED WATER LINE BELOW THE POTABLE WATER LINE.
  - PROVIDE A MINIMUM OF 12 INCHES OF VERTICAL SEPARATION BETWEEN POTABLE/ RECYCLED WATER/SEWER.
  - THE SITE IRRIGATION SYSTEMS AS SHOWN ON THESE DOCUMENTS WILL UTILIZE POTABLE WATER UNTIL SUCH TIME AS THE CITY OF SAN DIEGO MAKES RECYCLED WATER AVAILABLE TO THE SITE.
  - INSTALL PURPLE COLORED PANTONE #522 MATERIAL FOR ALL ABOVE GROUND IRRIGATION FACILITIES:
    - VALVE AND OTHER ON GRADE BOXES - INTEGRAL COLOR
    - BACKFLOW DEVICES - PAINTED 2 COATS OF ENAMEL
    - SPRINKLER HEADS - INTEGRAL COLOR PLASTIC
  - TAG ALL VALVES AND OTHER BELOW GRADE APPURTENANCES WITHIN BOXES WITH PERMANENT RECYCLED WATER LABELS IN BOTH ENGLISH AND SPANISH THAT IDENTIFY RECYCLED WATER IN USE ("RECYCLED WATER - DO NOT DRINK"). ATTACH THE LABEL WITH EITHER STAINLESS STEEL WIRE OR SELF LOCKING PLASTIC TIES.
  - THE REQUIRED INITIAL CROSS CONNECTION TEST SHALL BE DONE BY THE CITY OF SAN DIEGO PUBLIC UTILITIES DEPARTMENT AND MONITORED BY THE COUNTY OF SAN DIEGO DEPARTMENT OF ENVIRONMENTAL HEALTH. COPIES OF INSPECTION REPORTS WILL BE FORWARDED TO THE NON-INSPECTING PARTY.
  - THE DESIGN LOCATIONS PROPOSED FOR RECYCLED WATER "DO NOT DRINK" SIGNS SHALL BE CALLED OUT ON THE PLANS.
  - AN ANNUAL CROSS CONNECTION INSPECTION WILL BE DONE BY THE CITY OF SAN DIEGO. COPIES OF THE INSPECTION REPORTS WILL BE FORWARDED TO THE NON-INSPECTION PARTY. A CROSS CONNECTION TEST WILL BE PERFORMED EVERY FOUR YEARS.
  - PRIOR TO CONVERSION TO RECYCLED WATER, AN ON-SITE SUPERVISOR SHALL BE DESIGNATED IN WRITING. THIS INDIVIDUAL SHALL BE FAMILIAR WITH PLUMBING SYSTEMS WITHIN PROPERTY, WITH THE BASIC SPECIFIC REQUIREMENTS OF RECYCLED WATER SYSTEMS. THE DESIGNATED SITE SUPERVISOR SHALL ATTEND AN APPROVED CLASS FOR RECYCLED WATER SITE SUPERVISORS. COPIES OF THE SITE SUPERVISORS CERTIFICATE, WITH A 24-HOUR CONTACT NUMBERS SHALL BE PROVIDED TO THE CITY OF SAN DIEGO AND THE COUNTY DEPARTMENT OF ENVIRONMENTAL HEALTH.
- IN CASE OF EMERGENCY CONTACT: ROY KINLEY AT 619-388-7823
- AFTER HOURS CONTACT: MIRAMAR COLLEGE POLICE DEPARTMENT DISPATCH AT 619-388-6406
- A PHYSICAL SEPARATION SHALL BE PROVIDED BETWEEN ADJACENT AREAS IRRIGATED WITH RECYCLED WATER AND POTABLE WATER. SEPARATION SHALL BE PROVIDED BY DISTANCE, CONCRETE MOW STRIPS OR OTHER APPROVED METHODS.
  - CALL OUT ON THE PLANS IF THERE ARE OR ARE NOT ANY DRINKING FOUNTAINS AND/OR DESIGNATED OUTDOOR EATING AREAS ON THE SITE.
  - ALL PUBLIC AND PRIVATE POTABLE WATER MAINS INCLUDING FIRE MAINS AND ANY WATER WELLS AND WATER COURSES WITHIN THE RECYCLED WATER PROJECT SHALL BE SHOWN ON THE PLANS.
  - EDUCATE ALL MAINTENANCE PERSONNEL ON A CONTINUOUS BASIS OF THE PRESENCE OF RECYCLED WATER. PERSONNEL MUST BE INFORMED THAT RECYCLED WATER IS MEANT FOR IRRIGATION PURPOSES ONLY, AND IS NOT APPROVED FOR DRINKING PURPOSES, HAND WASHING, CLEANING OF TOOLS, ETC. GIVEN THE HIGH TURNOVER RATE OF EMPLOYEES IN THE LANDSCAPE INDUSTRY, IT IS IMPORTANT THIS INFORMATION BE DISSEMINATED ON AN ALMOST DAILY BASIS.
  - PRIOR TO INSTALLATION OF ANY RECYCLED WATER WORK, IT MUST BE INSPECTED BY RECYCLED WATER PROGRAM PERSONNEL. THE INITIAL CROSS CONNECTION TEST SHOULD BE PERFORMED USING POTABLE WATER WITH AN APPROVED BACKFLOW DEVICE.
  - ALL INITIAL IRRIGATION SHALL USE POTABLE WATER. NO RECYCLED WATER SHALL BE USED UNTIL THE SITE HAS PASSED THE CROSS- CONNECTION TEST AND HAS BEEN APPROVED BY THE CITY OF SAN DIEGO AND COUNTY OF SAN DIEGO.

Wimmer Yamada and Caughey  
Landscape Architecture | Environmental Planning  
9067 Fifth Avenue, San Diego, California 92121-0440  
760-333-0010 | 760-333-0660 www.wymca.com

LANDSCAPE ARCHITECT OF WORK  
PATRICK CAUGHEY LA. NO. 2895 DATE: D.S.A.

## CITY OF SAN DIEGO WATER PRESSURE ZONES:

- EXISTING RECYCLED WATER MAIN ON HILLERY DRIVE IS RECYCLED WATER PRESSURE ZONE No. 890 (ALL IRRIGATION SHOWN ON THESE PLANS IS RECYCLED WATER FROM THIS ZONE).
- EXISTING POTABLE WATER IS PRESSURE ZONE No. 712.

CITY OF SAN DIEGO  
WORK ORDER No. 539264

## WYAC PROJECT #12-003.001

	APPROVED BY	APPROVED BY	DRAWN	<b>IRRIGATION SCHEDULE AND NOTES</b>  MIRAMAR COLLEGE INFRASTRUCTURE AND SITE DEVELOPMENT PHASE II ( SOUTH ) SCOPE "B"  SAN DIEGO COMMUNITY COLLEGE DISTRICT	DATE SEPTEMBER 1, 2017
			CHECKED		SHEET <b>LI-2.1</b>
			REVISION		OF <b>44</b>

SYMBOL	MANUFACTURER/MODEL/DESCRIPTION	PSI	DETAIL
	HUNTER MP1000 PROS-06-PRS40-CV-R TURF ROTATOR, 6" (15.24 CM) POP-UP WITH CHECK VALVE, RECLAIMED BODY CAP, PRESSURE REGULATED TO 40 PSI (2.76 BAR), MP ROTATOR NOZZLE ON PRS40 BODY. M=MAROON ADJ ARC 90 TO 210, L=LIGHT BLUE 210 TO 270 ARC, O=OLIVE 360 ARC.	40	O/LI-3.2
	HUNTER MP2000 PROS-06-PRS40-CV-R TURF ROTATOR, 6" (15.24 CM) POP-UP WITH CHECK VALVE, RECLAIMED BODY CAP, PRESSURE REGULATED TO 40 PSI (2.76 BAR), MP ROTATOR NOZZLE ON PRS40 BODY. K=BLACK ADJ ARC 90-210, G=GREEN ADJ ARC 210-270, R=RED 360 ARC.	40	O/LI-3.2
	HUNTER MP3000 PROS-06-PRS40-CV-R TURF ROTATOR, 6" (15.24 CM) POP-UP WITH FACTORY INSTALLED CHECK VALVE, RECLAIMED BODY CAP, PRESSURE REGULATED TO 40 PSI (2.76 BAR), MP ROTATOR NOZZLE ON PRS40 BODY. B=BLUE ADJ ARC 90-210, Y=YELLOW ADJ ARC 210-270, A=GRAY 360 ARC.	40	O/LI-3.2
	HUNTER MP800SR PROS-06-PRS40-CV-R TURF ROTATOR, 6.0" POP-UP WITH CHECK VALVE, PRESSURE REGULATED TO 40 PSI (2.76 BAR), MP ROTATOR NOZZLE ON PRS40 BODY. AD=ORANGE AND GRAY ( ARC 90-210), 360=LIME GREEN AND GRAY (ARC 360)	40	O/LI-3.2
	HUNTER MP CORNER PROS-06-PRS40-CV-R TURF ROTATOR, 6" (15.24 CM) POP-UP WITH FACTORY INSTALLED CHECK VALVE, RECLAIMED BODY CAP, PRESSURE REGULATED TO 40 PSI (2.76 BAR), MP ROTATOR NOZZLE ON PRS40 BODY. T=TURQUOISE ADJ ARC 45-105.	40	O/LI-3.2
	HUNTER MP1000 PROS-12-PRS40-CV-R SHRUB ROTATOR, 12" (30.48 CM) POP-UP WITH CHECK VALVE, PURPLE CAP, PRESSURE REGULATED TO 40 PSI (2.76 BAR), MP ROTATOR NOZZLE. M=MAROON ADJ ARC 90 TO 210, L=LIGHT BLUE 210 TO 270 ARC, O=OLIVE 360 ARC ON PRS40 BODY.	40	O/LI-3.2
	HUNTER MP2000 PROS-12-PRS40-CV-R SHRUB ROTATOR, 12" (30.48 CM) POP-UP WITH FACTORY INSTALLED CHECK VALVE, RECLAIMED BODY CAP, PRESSURE REGULATED TO 40 PSI (2.76 BAR), MP ROTATOR NOZZLE. K=BLACK ADJ ARC 90-210, G=GREEN ADJ ARC 210-270, R=RED 360 ARC ON PRS40 BODY.	40	O/LI-3.2
	HUNTER MP800SR PROS-12-PRS40-CV-R SHRUB ROTATOR, 12.0" POP-UP WITH CHECK VALVE, RECLAIMED PURPLE BODY CAP, PRESSURE REGULATED TO 40 PSI (2.76 BAR), MP ROTATOR NOZZLE ON PRS40 BODY. OR = ORANGE ADJ ARC 90 TO 210.	40	O/LI-3.2
	HUNTER MP CORNER PROS-12-PRS40-CV-R SHRUB ROTATOR, 12" (30.48 CM) POP-UP WITH CHECK VALVE, PURPLE CAP, PRESSURE REGULATED TO 40 PSI (2.76 BAR), MP ROTATOR NOZZLE. T=TURQUOISE ADJ ARC 45-105 ON PRS40 BODY.	40	O/LI-3.2
	HUNTER MP STRIP PROS-12-PRS40-CV-R SHRUB ROTATOR, 12" (30.48 CM) POP-UP WITH FACTORY INSTALLED CHECK VALVE, RECLAIMED BODY CAP, PRESSURE REGULATED TO 40 PSI (2.76 BAR), MP ROTATOR NOZZLE. LST=IVORY LEFT STRIP, SST=BROWN SIDE STRIP, RST=COPPER RIGHT STRIP ON PRS40 BODY.	40	O/LI-3.2
	RAIN BIRD 1812-SAM-5 SERIES STREAM W/PCS STREAM BUBBLER 12.0" POPUP WITH CHECK VALVE AND PRESSURE COMPENSATING SCREEN, PURPLE CAP.	30	N/LI-3.2
	RAIN BIRD XCZF-100-PRF MEDIUM FLOW DRIP CONTROL KIT, 1" DV VALVE WITH 1" PRESSURE REGULATING FILTER AT 40PSI, AND MDCF FITTING. 3GPM-15GPM.		R/LI-3.2
	RAIN BIRD XCZ-150-PRB-COM HIGH FLOW CONTROL ZONE KIT, FOR LARGE COMMERCIAL DRIP ZONES. 1-1/2" FESB VALVE WITH TWO 1" PRESSURE REGULATING (40PSI) QUICK-CHECK BASKET FILTERS. FLOW RANGE: 15-40GPM.		R/LI-3.2
	RAIN BIRD MDCFPCAP DRIPLINE FLUSH VALVE PURPLE CAP IN COMPRESSION FITTING COUPLER. FOR NON-POTABLE WATER USE.		S/LI-3.2
	RAIN BIRD ARV050 1/2" AIR RELIEF VALVE, MADE OF QUALITY RUST-PROOF MATERIALS, WITH A 6.0" DRIP VALVE BOX (SEB 7XB EMITTER BOX). USE WITH INSTALLATION BELOW SOIL. THE VALVE WILL ALLOW AIR TO ESCAPE THE PIPELINE, THUS PREVENTING WATER HAMMER OR BLOCKAGE.		T/LI-3.2
	RAIN BIRD OPerIND DRIP SYSTEM OPERATION INDICATOR, STEM RISES 6" FOR CLEAR VISIBILITY WHEN DRIP SYSTEM IS CHARGED TO A MINIMUM OF 20PSI. INCLUDES 16" OF 1/4" DISTRIBUTION TUBING WITH CONNECTION FITTING PRE-INSTALLED.		U/LI-3.2
	AREA TO RECEIVE DRIPLINE RAIN BIRD XFS-06-12 (12) XFS SUB-SURFACE PRESSURE COMPENSATING LANDSCAPE DRIPLINE W/COPPER SHIELD TECHNOLOGY. 0.6GPH EMITTERS AT 12.0" O.C. DRIPLINE LATERALS SPACED AT 12.0" APART, WITH EMITTERS OFFSET FOR TRIANGULAR PATTERN. PURPLE TUBING FOR NON-POTABLE WATER.		V/LI-3.2 W,X,Y/LI-3.3

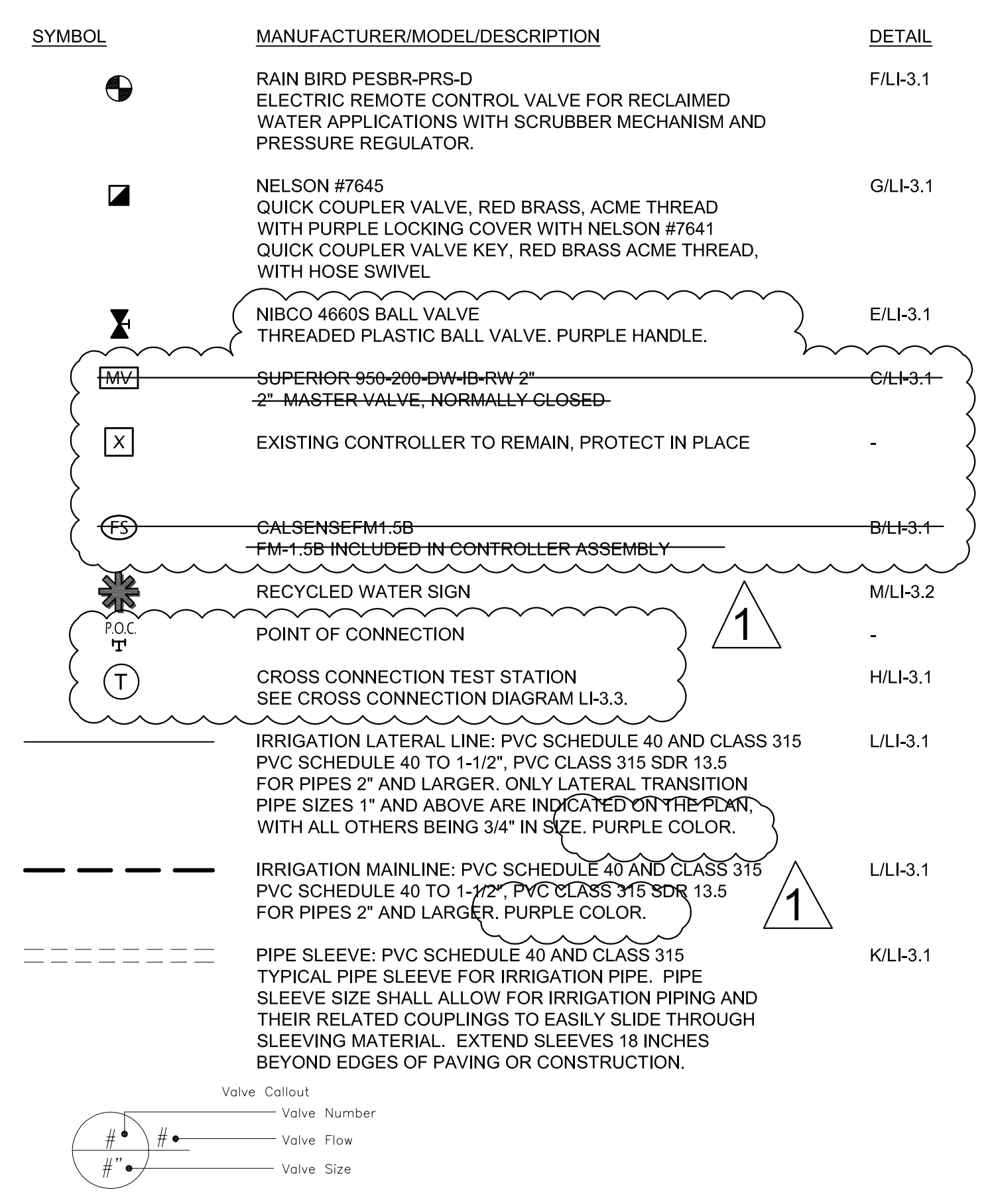

2017-09-01 - 100% CONSTRUCTION DOCUMENTS - SCOPE "B"